



### Manchester facts:

- ❑ Located in the North West of England.
- ❑ 3<sup>rd</sup> largest city in the UK.
- ❑ Population 2.5 million (Greater Man).
- ❑ 2h train away from London, 3.5h from Edinburgh and Bristol, 1.5 from York and Blackpool, 0.5h from Liverpool.
- ❑ Leading universities and growing business and investments.
- ❑ Easy and affordable public transport.
- ❑ Named one of the friendliest cities.
- ❑ World's first computer was built here.
- ❑ First public lending library opened here.



# HIGHLIGHTS

## PICCADILLY AND CITY CENTRE

The centre of Manchester with main transport links, shops, cafés, restaurants, and bars.

**Piccadilly Gardens** – a central square in Manchester surrounded by shops and restaurants. Here you can also catch a bus or a tram to other parts of the city. The school is located just 2 min walk away.







Communicate students in Piccadilly Gardens

**Market Street and Arndale Shopping Centre** – one of the main shopping districts in Manchester – always busy and filled with street entertainers. 10 min walk from the school.





**Printworks** – an entertainment centre with Odeon cinema, bars and clubs – the perfect place for a night out with friends. 10 minutes walk from the school.



**St Peter's Square and Albert Square** – some of the most beautiful landmarks in Manchester: Manchester Central Library and the Town Hall. Every Christmas this part of the city turns into a spectacular Christmas market. Other festivals such as food and music festivals as well as St. Patrick's Day celebrations and open air sports events also take place in Albert Square – it's definitely the place to be! 5 minutes walk from the school.

*St Peter's Square*







*Albert Square – Christmas Market*





**NORTHERN QUARTER** – The Northern Quarter is Manchester's intensely trendy, bohemian area. Independent cafés, bars, and live-music venues line the streets, and men in horn-rimmed glasses shop for vintage clothing and vinyl. Here you can find hundreds of students and locals. 5 minutes walk from the school.





**SPINNINGFIELDS** – the business district of the city with posh offices, designer brands and trendy bars and restaurants. The so called “white collar” district. It is busy in the winter with a great ice-skating ring and in the summer with an open-air cinema. 10 min walk from the school.

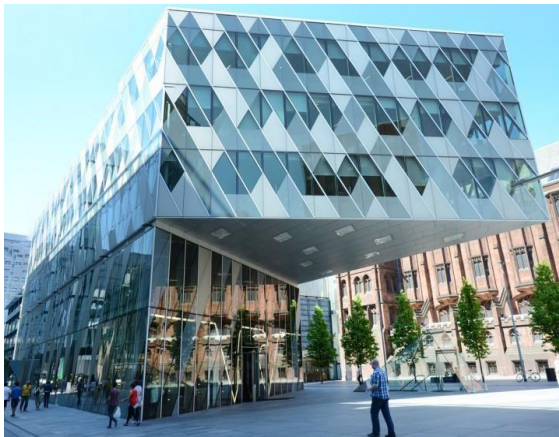



**DEANSGATE** - If you're looking for a slightly classier night out or meal, it can be found at the south end of Deansgate. Areas such as this and the Northern Quarter might be more expensive, but are often worth it for the change of location and special experience. There is also a budget cinema – AMC (remember to bring your student card!). Deansgate Locks has a selection of bars and clubs with popular music and a good atmosphere. Deansgate is also home to the famous Hilton hotel – the tallest building in the city with amazing view from Cloud 23 bar. 15 min walk from the school.





**CASTLEFIELD** is the largest conservation area in the city. Roman soldiers marched into the north-west of England in 79AD. For strategic reasons they selected the Castlefield location for a fort, called Mamucium. This is the first definite record of human settlement in Manchester. Now this area is full of pubs, restaurants, bars and modern accommodation overlooking the canal. 15 min walk from the school.



*The Wharf – one of the most popular pubs in Castlefield*



TRAFFORD is home to Old Trafford and The Trafford Centre – one of the biggest shopping centres in the UK. 15-20 bus ride from the school.



*Trafford Centre – one of the biggest shopping & leisure centres in the UK*



**HEATON PARK** – only 30 min bus ride away is the largest park in the vicinity of the city. Here you can find a boating lake, golf course, animal farm, woodlands, gardens, and every June one of the largest music festivals in the UK – Parklife.





## NEARBY ATTRACTIONS –

There is plenty to see around Manchester. From beautiful beaches and mountains to historical cities and castles.

- Liverpool- 35 mins by train
- Lake District- 1h 40 mins by train
- Peak District- 1h 15 mins by train
- Blackpool- 1h 25 mins by train
- Chester- 1h by train
- York- 1h 20 mins by train



*The Lake District*



*Liverpool*



*The Peak District*



*Chester*



*York*



*Blackpool beach*



[Festivals in Manchester](#)- There are many different festivals in Manchester especially during the summer and many of them are free!

Manchester Jazz Festival- 22<sup>nd</sup>-31<sup>st</sup> July 2016

- 10 days of live music
- Many free concerts
- Over 400 musicians and 80 events in 7-10 venues
- Brings the best contemporary jazz to Manchester from the region, the UK and abroad.



Manchester Food and Drink Festival- 29<sup>th</sup>September-10<sup>th</sup> October 2016

- An Urban food and drink festival that takes over the whole city.
- Get the chance to try food from all over the world.

Manchester Histories Festival- 3<sup>rd</sup>- 12<sup>th</sup> June 2016

- A 10 day festival celebrating local history in Manchester.
- Exhibitions, talks, film screenings, games and lots more.





## Why study in Manchester? Blog post by Marta Cereszkiewicz, student at Communicate School.



I would like to share my experience of living in Manchester with you. I can honestly tell you that Manchester has stolen my heart! It's a beautiful and vibrant city to live in.

If you come to Manchester you will be surprised by how **friendly and nice the people are here!** You definitely won't feel lonely in this cosmopolitan city.

On the first day I would recommend spending some time in **Piccadilly Gardens** and see places near our school. There are a lot of shops here and if you are lucky you can get some nice things on sale.

You will never be bored here. It is worth having a pint of traditional ale in a **local pub and experience a true English atmosphere**. If you are a party animal you must go to the **Printworks where there are lots of bars and clubs**. Another place to spend an excellent night out is the Gay Village on Canal Street. My first time there was one of the biggest "wow" nights ever!

**Museums in Manchester are a must.** There are quite a few and each one has different exhibitions. **Visit Manchester Central Library** for a deeper understanding of the history of Manchester.

I didn't use to be the biggest fan of international food. I am Polish and I love my native food but **here I totally changed my mind and taste**. China Town is an excellent place to try some of the delicious food and experience Chinese culture. The Curry Mile is an excellent place to try good quality Indian food. It is not hard to find places serving Italian, Spanish or Persian food; the international cuisine will surprise your taste buds.

If you are worried about how to get around the city, the Metrolink will take you almost everywhere, and you should try it at least once. However, I normally travel by bus – it will take you anywhere and it is much cheaper. Anyone visiting Manchester should visit the Manchester football stadiums (Etihad Stadium and Old Trafford), or even buy one of the Manchester City or United shirts.

When the weather is nice you should go for a walk to one of the biggest parks – Heaton Park. It is absolutely massive and this year I had a chance to spend 2 days at a festival there. You would be surprised by the size of the park.

In the winter it can get dark quite early, but don't worry, there are lots of bright and vibrant things to keep you occupied. Albert Square gets transformed into the **German Christmas markets**, a must-see for food and drink lovers. It is also a great place to buy gifts for your family and friends for Christmas. Spinningfields usually has an ice skating rink and you can hire ice skates and after all the fun have a hot drink in the Winter Bar next door.

There is so much more to write about Manchester, however, you should come over and check it out for yourself. I am sure that you will have the time of your life here!